

Del. - PIKE.

4 ✓

Lehman ✓

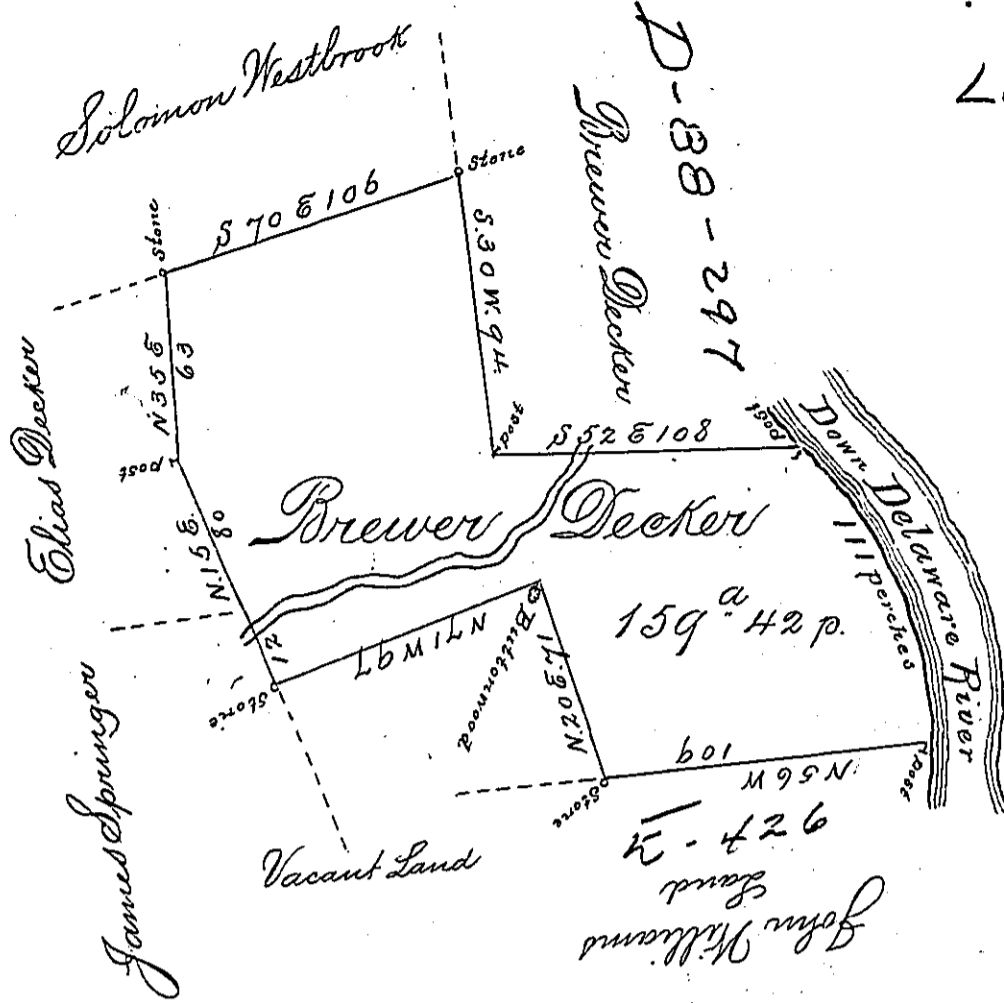

The bearings and Dist
Down Delaware River
are as follows

- 1. S. 13 W. 52.
 - 2. S. 25 W. 59.0.
- total 111.

By Virtue of a Warrant dated 20th of December 1750
Survey^d the 17 of May 1793 to Brewer Decker the above
Described Tract of Land situate in Delaware Town-
ship Northampton County (formerly Bucks County)
Containing One Hundred fifty nine Acres & forty two
Perches of Land and the Allowance of six p^a p^a
p Geo Palmer

To Daniel Brodhead Esq^r }
Surveyor General }

IN TESTIMONY that the above is a copy of the original remaining on file in
the Department of Internal Affairs of Pennsylvania, made
conformably to an Act of Assembly approved the 16th day of
February, 1833, I have hereunto set my Hand and caused
the Seal of said Department to be affixed at Harrisburg,
this fourth day of October 1898.

James W. Lewis
Secretary of Internal Affairs.